

PROPOSAL ONLY NOT FOR CONSTRUCTION

NOTES:

1. SERVICES TO BE REVERSED ON OPPOSITE HAND UNITS.
2. ALL UNITS ARE TO BE BUILT FOR MOUNTING INTO 3-5/8" (SINGLE SIDED) OR 6" (DOUBLE SIDED) METAL STUD WALLS WITH 5/8" DRYWALL.
3. PICTURE FRAME IS SHOWN IN UP POSITION. FRAME SLIDES DOWN AND OVER TO CONCEAL GAS SERVICES. FRAMED (28"W X 24"H) ARTWORK BY OTHERS MOUNTING KIT INCLUDED.
4. ARTWORKS CAN TO BE POWDER COATED TO MATCH FORMICA #923 "SURF".

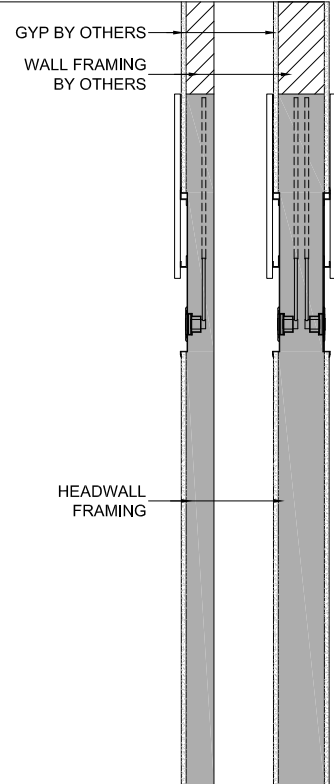
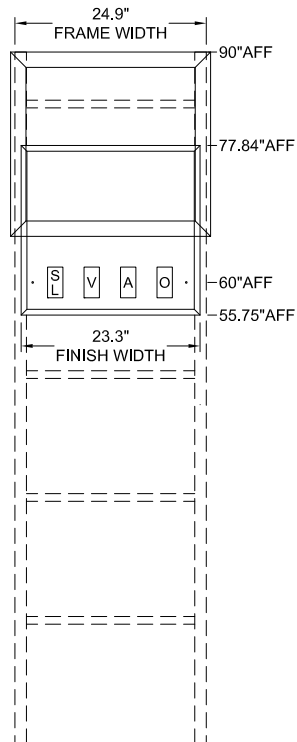

LEGEND:

ACCESSORIES NOT SHOWN (PER UNIT)

REQ	SYM	DESCRIPTION	REQ	SYM	DESCRIPTION	REQ	DESCRIPTION
	O	OXYGEN OUTLET					
	A	AIR OUTLET					
	V	VACUUM OUTLET					



500 EAST BRITTON ROAD  
OKLAHOMA CITY, OK 73114  
www.modularservices.com

TOTAL QTY:  
**X**

ARTWORKS® FLUSH MOUNTED, 3 GAS  
MODEL 6813-F & 6823-F

AS SHOWN:  
X

DRAWN BY:  
XXX

DRAWING: **4XXXX**

OPPOSITE:  
X

DATE:  
XX/XX/XX

PROJECT #:  
XXXX

SALES ORDER #:  
XXXXX

HOSPITAL  
PROJECT  
CITY, STATE

PROJECT